

## A Single Window for All Building Data and Modules

The Building Dashboard provides accurate data on every type of space and equipment classified using the standard Uniformat II. Users can visualize the building in 2D by floor, unit, room, and workstation with floor plans in .SVG and .PDF format and a color-coded legend.

Data shown in the Building Dashboard is extracted from AutoCAD drawings and Revit files, ensuring that it is always up to date. Quick links present in the Dashboard can be configured according to client requirements, giving access to building documents or other Archidata modules.

The Archidata Solution is based on a single window approach for all building information.

### BENEFITS

- Provides accurate information easily
- Provides interactive floor plans with spaces and equipment
- Provides access to all Archidata Modules from a single screen
- Converts graphic information into management data and vice versa
- Shares accurate data between building systems and enterprise software
- Saves time and money

### QUICK LINKS

|                  |                |               |                 |
|------------------|----------------|---------------|-----------------|
| Leasing          | Stacking       | Plan Room     | Archidata World |
| Evacuation Plans | Asset          | Documents     | BIM/IFC         |
| Legal Info       | Financial Info | Leasing       | Stacking        |
| IAQ Report       | Technical Info | Search Spaces | Search Objects  |

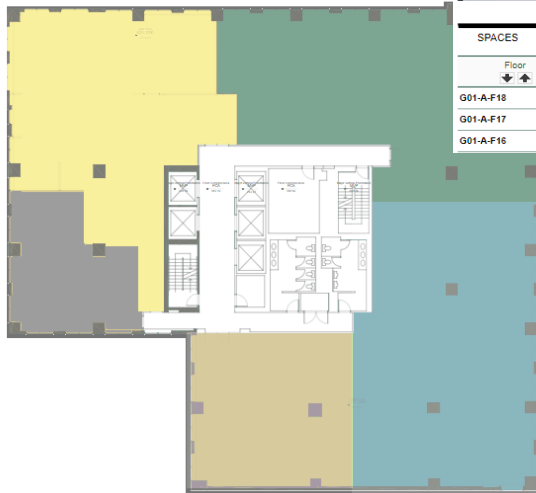
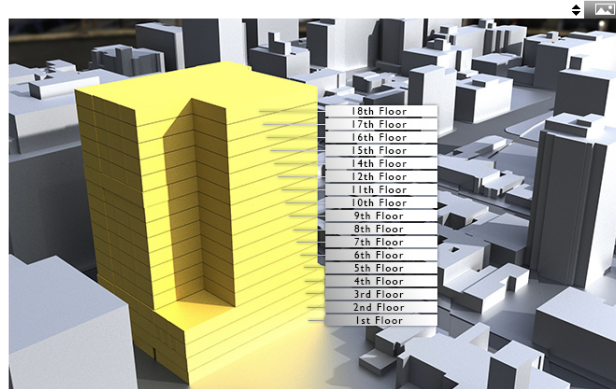

OCCUPANCY FLOOR PLAN

| SPACES | UNITS | TENANTS | Zones | Object Type       |
|--------|-------|---------|-------|-------------------|
|        |       |         |       | Floor Zones       |
|        |       |         |       | Unit Zones        |
|        |       |         |       | Room Zones        |
|        |       |         |       | Workstation Zones |
|        |       |         |       | Project Zones     |

### SPACES INFO

| Object Type      |
|------------------|
| [A] Substructure |
| [B] Shell        |
| [C] Interior     |
| [D] Services     |
| [E] Equipment    |
| [F] Construction |
| [G] Site work    |